

AZTRON[®]

AIR WING USER GUIDE



www.aztronsports.com



Thank You for Choosing AZTRON – Air Wing Introduction

Wing foiling is gaining popularity at an incredible pace, offering outstanding performance in speed, freestyle, and especially in wave riding. Performance, simplicity, and lightness are the core values behind our Air Wing design.

The Air Wing is primarily developed for wing foiling, but its versatility goes far beyond that. You can also use it without a foil — on a SUP, surfboard, or kiteboard when wind conditions are strong. On land, it performs just as impressively on rollerblades, surfskates, or even snowboards.

By investing in this product, you unlock an entirely new world of possibilities. We wish you years of adventure, enjoyment, and unforgettable experiences with your Air Wing.

INDEX

WING INTRODUCTION	3
PRODUCT OVERVIEW AND PART LIST	7
HANDLING AND PRECAUTIONS FOR USE	5
WARNING AND COMMON WATER SENSE	5
INFLATION	9
DEFLATION AND PACK UP	10
RIGID HANDLE	12
MAINTENANCE	12
REPAIR	12
SERIAL NUMBER	13
WARRANTY	14

USER AGREEMENT & SAFETY NOTICE

By assembling or using this Aztron product, you confirm that you have read and fully understood this Aztron User Manual, including all instructions, safety guidelines, and warnings contained within the manual and printed on the product.

You also agree to ensure that any additional or subsequent users of this Aztron product read and fully understand the entire User Manual, including all instructions and warnings, before allowing them to use the product.

ASSUMPTION OF RISK

Wing foiling is a hazardous activity. The use of any Aztron product involves inherent risks and dangers that may result in serious injury or death to the user and others. By using this Aztron product and any of its components, you voluntarily agree to assume and accept all known and unknown risks of injury to yourself and to non-user third parties arising from the use of this equipment.

The risks, dangers, and hazards associated with wing foiling can be significantly reduced by carefully following the instructions and warnings contained in this User Manual and by exercising common sense and good judgment.

WARNING:

DOWNLOAD AND READ ALL USER MANUALS AND INSTALLATION GUIDES RELATING TO ALL YOUR EQUIPMENT BEFORE USE, AND ENSURE YOU ALWAYS CHECK ALL PARTS OF YOUR PRODUCT THOROUGHLY BEFORE EACH USE. FAILURE TO DO SO MAY RESULT IN PERSONAL INJURY OR DEATH.

For your safety and the safety of others, we strongly recommend that you receive proper instruction from a certified professional before using this product. This User Manual is not a substitute for professional training or lessons.

HANDLING AND PRECAUTIONS FOR USE

1. Always put your Wing on a clean, unobstructed surface, without seashells, objects or plants that may cut or perforate.
2. Always secure your Wing on the beach using a leash, sand, or a weighted bag filled with sand. This helps prevent the wing from being blown away by the wind and causing damage or injury.
3. Inflate your Wing until it is firm and rigid, but do not over-inflate. Over-inflation can cause the wing to burst, especially when handled roughly or used in strong waves.
4. Always use your Wing with a leash attached. The leash helps prevent you from losing your wing in sudden gusts of wind. The leash is not designed to withstand violent pulling, especially in waves. Avoid yanking the wing forcefully to prevent damage or injury.
5. Do not allow your Wing to be carried away by a wave. If this happens, do not pull on the Leash. The force and weight of moving water are extremely powerful. Pulling in the opposite direction increases the risk of tearing or damaging your wing and may cause injury.
6. Do not pump your Wing violently or unnecessarily. Learn to recognize the minimum wind strength required for flight based on your wing size and body weight. Excessive or aggressive pumping when the wind is insufficient places excessive stress on the fabric and seams, increasing the risk of damage to your Wing.
7. In the event of a fall while foiling, avoid landing on the foil and do not let your Wing come into contact with it. The foil's stab or front wing can easily pierce your wing.
8. When passing over the bar with your Wing, keep it out of the water. Avoid putting your Wing in the waves, keep it in the air as much as possible.
9. Your Wing can be used with skateboards, rollerblades, or mountain boards, but this is not its main purpose. Avoid dragging it on hard surfaces—wear from land use isn't covered by Aztron.

SAFTY WARNINGS AND COMMON WATER SENSE

1. Wings can be dangerous depending on their size and the wind strength. Always check your wing's wind range and match it to your real abilities. Never underestimate its pulling force—even a beginner wing can generate several hundred kilos of pull.
2. Check the weather before practicing. Avoid strong winds and gusts, and never sail in offshore winds. Ideal conditions are a steady 15–25 knot crosswind toward the shore.
3. For your first sessions, avoid using your wing in its high-wind range.

4. Do not use your Wing in a shorebreak or waves that are too powerful.
5. Use your wing in a safe environment. Take time to learn how to handle it under optimal safety conditions. Only fly your wing in open, unobstructed areas.
6. Choose the appropriate wind-wing for your body size, ability and the conditions.
Do not use a wing size that is beyond your control. If conditions change while you are on the water and you can no longer control your equipment, return to shore. Do not go out in conditions that are beyond your skill level.
7. Know your limits. Ensure you are in good physical condition and have no medical restrictions. Misuse can cause serious injury or death to you or others.
8. When navigating, constantly check the water in front of you to avoid any collision or non-respect for the rules of priority at sea. Keep in mind that you are potentially dangerous for yourself and for others.
9. We strongly recommend subscribing to insurance that covers Wingfoil practice.
10. Only use this product if you are a strong swimmer.
11. Check your equipment thoroughly prior to each use. Do not launch your wing if it is damaged in anyway.
12. Always equip yourself with safety gear: helmet, leash, and a Personal Flotation Device (PFD) or impact vest."
13. When using your Wing, ride smart and have common sense, respect nature and help others safely if needed.

THIS LIST OF RECOMMENDATIONS IS NOT EXHAUSTIVE AND DOES NOT REPLACE PROPER KNOWLEDGE OR SERIOUS STUDY OF SEA SAFETY AND NAVIGATION RULES. FOILING IS A DANGEROUS SPORT AND SHOULD NOT BE IMPROVISED.

PRODUCT OVRVIEW & PART LIST

RADIUS 4.0 / 5.0

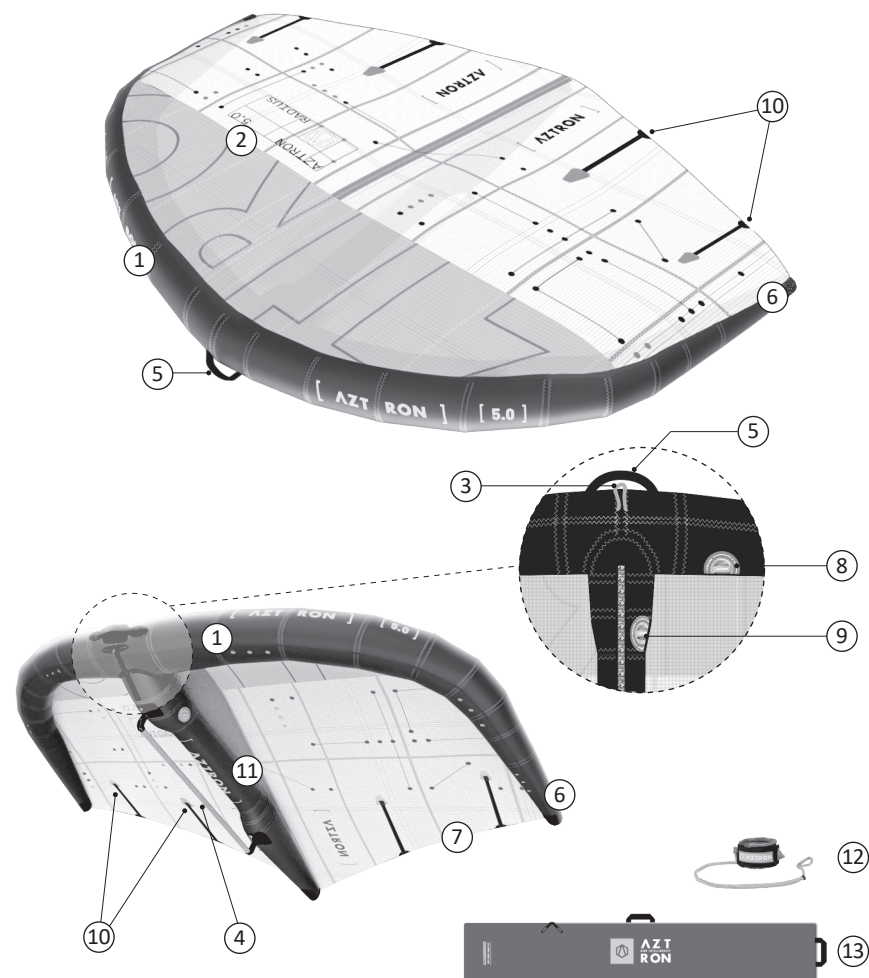

- 1 - Leading edge
- 2 - Canopy
- 3 - Leash attachment
- 4 - Rigid carbon handle
- 5 - Nylon handle

- 6 - Ears / Tips
- 7 - Trailing edge
- 8 - Inflation valve
- 9 - Inflation valve of central strut
- 10 - Fiber battens

- 11 - Inflatable central strut
- 12 - Safety wrist leash
- 13 - Gear bag

PRODUCT OVRVIEW & PART LIST

SOAR AND AIM 3.0 / 4.0 / 5.0

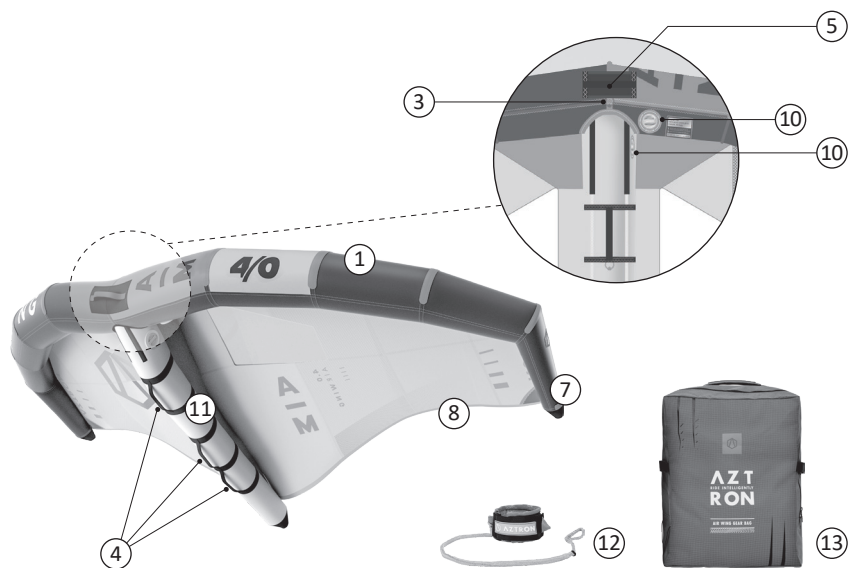

1 - Leading edge
2 - Canopy
3 - Leash attachment
4 - Multiple handles
5 - Front nylon handle

6 - Windows
7 - Ears / Tips
8 - Trailing edge
9 - Inflation valve
10 - Inflation valve of central strut

11 - Inflatable central strut
12 - Safety wrist leash
13 - Gear bag 78L

WING INFLATION

IMPORTANT:

ALWAYS INFLATE YOUR WING USING A HAND PUMP WITH A PRESSURE GAUGE.

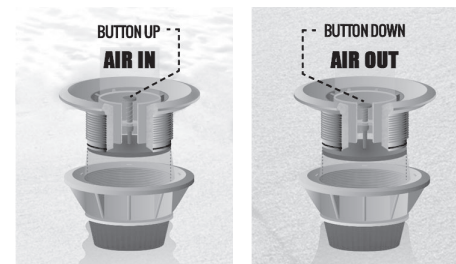

1. Unpack the Wing from the Wing Gear Bag. Remove the compression strap, and lay the unrolled wing on a flat surface, free from hard or sharp objects, with the Leading Edge (LE) into the wind and the strut facing up.
 2. Open the valve cap.
 3. Attach the Pump hose to the valve. Turn it clockwise for a safe connection.
 4. The AZTRON Pump is a Double Action Pump. Pump the Wing with the Air Screw closed for double stroke action and take the Air Screw out when the double stroke gets too exhausting.
- IMPORTANT:** Always secure the pump base with your feet while the Wing is attached.
5. Inflate to the recommended PSI printed on the LE of the Wing, next to the inflation valve. It is common for the LE to inflate before the strut.

WARNING:

If the bladder has moved or twisted inside the strut or LE, it can cause a rupture or bulge when inflated. To prevent this, you must ensure the bladder has even and direct contact with the material surrounding it during inflation, this material is not over or under-tensioned in any area, and there is no twisting or distortion.

WARNING:

Always use a hand pump with a pressure gauge to inflate your wing. Do NOT inflate your wing with an air compressor. Overinflation will damage the Wing and void any warranty. Follow PSI guidelines printed on the Wing next to the inflation valve.

6. When your wing is fully inflated, remove the pump hose and keep hold of the wing. Ensure the valves are secured tightly to the valve bases on the LE. Then screw the inflation valve cap securely back in place.

HOW TO INFLATE/DEFLATE YOUR WING

1 MAKE SURE THE PUSH-PIN IS IN UPPER POSITION BEFORE INFLATING

2 PUSH THE PIN DOWN TO DEFLATE

DO NOT GET SAND IN THE VALVE

3 MAKE SURE THE INFLATING PIPE IS CLEAN OF SAND BEFORE PLUGGING IN



Unfold the wing with leading edge facing the wind on a clear surface. Check if the valve is in the pin-out/upper position. The valve must be released for inflation. Unscrew the valve cap, push downwards and twist left or right until the pin's upper position is found.



Insert the nozzle of the pump. Turn it clockwise for a safe connectin.



Follow the Maximum Pressure indicated on the Warning Pad. Do not overinflate your wing. The pressure gauge is for reference only.

Recommended pressure: 6–8 PSI, as stated on the Warning Label.

DEFLATION



Clear any water or debris out of the valve area before deflation. Slowly press down the valve pin to start letting air out. You can also use the Hand Pump to deflate. Once the air flow has slowed down, press the pin all the way down and turn it clockwise to lock it onto the "OPEN" position.



Use 3 Check Points to help you verify the inflation status:

[A] The Central Strut:

The central strut must not show any bulges between the reinforcements.

→ Bulging indicates over-inflation.

[B] When pressing the center section of the leading edge,

the wing should feel firm and show slight folds.

→ If it does not bend at all, it is over-inflated.

FIBER BATTENS



For **RADIUS Wing**, the built-in fiber battens can be removed for storage if needed; however, we do not recommend removing them during regular use to avoid loss.

IMPORTANT:

Use fresh water to wash any sand or dirt from the window before packing up. Take care if using a cloth to wipe the window as any residual grit could scratch the surface. Allow the canopy and leash to dry completely before packing the wing into its bag. Never store your wing wet or moist in your bag for an extended period. This can cause colour migration, which will render the warrant void.

PACK UP

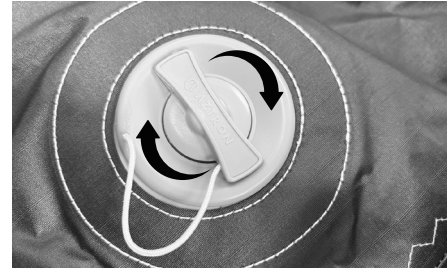

Open the Valve cap and push down the button to release the air.

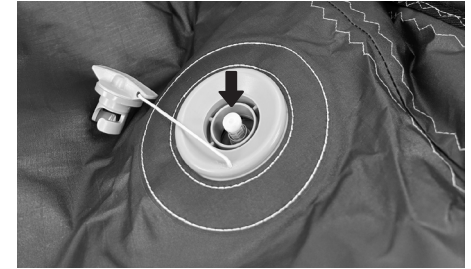

Unscrew the valve anticlockwise to deflate the LE and Strut.



Fold the trailing edge, then roll one end of the wing toward the center, gently squeezing to release all the air. Repeat from the other end toward the central strut. Finally, place the two rolled sections on top of each other.



Fold the wing neatly between the two handles.



Fit the wing into the gear bag, ensuring the leading-edge handles are facing up.

REMOVING RIGID HANDLE

The RIGID HANDLE comes pre-installed on the product



The Carbon Handle can be removed for storage purpose. Place the unfolded and deflated wing with its extrados facing the ground. Unscrew the M6 x 20 screws at each end of the handle and pull on the bends to extract them from their wing.



WARNING: Carry out these operations sheltered from the wind in order to prevent sand from infiltrating between parts during assembly.

Make sure to store the handle and components properly for future use.

NOTICE OF VIGILANCE

For wings with windows: to maintain visibility and safety, always roll from the tips toward the central batten, then fold carefully. Avoid pinching the PVC window.

MAINTENANCE

- Inspect regularly: Check your wing for holes or snags and repair them promptly.
- Avoid fresh water rinse: Tap water's chlorine can damage surface treatments.
- Protect the bladders: Prevent water or sand from entering during inflation/deflation.
- Dry flat: Hang-drying can shift the bladder, risking folds or hernias at the next inflation.
- Remove sand before storage: Keep the wing clean before folding.
- Store out of sunlight: Keep your wing away from sun and moon when not in use.
- Do NOT use rocks, stones, foils, or other abrasive objects to secure your wing.

REPAIR

WARNING:

The self-adhesive Canopy Repair Patches supplied within the Wing Repair Kit offers a temporary repair measure for the canopy material and LE Bladders. Major cuts, tears or leaks will need to be professionally repaired, or the bladder may need to be replaced. Please contact your local Aztron Retailer for support to carry out the repair.

The Wing Repair Kit is in the pocket of the Aztron Wing Bag. The Repair Kit Includes:

- 1 x Canopy Material
- 1 x LE Edge and Strut Reinforced Material
- 1 x Canopy Repair Patches
- 1 x Valve Wrench

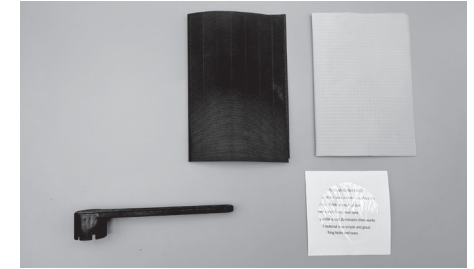

For major tears in the canopy material, we recommend you consult your Aztron Dealer or local service center.

1. Clean and dry the wing with fresh water in the area requiring repair. Do NOT use acetone, thinner or other mineral oil-based cleaning products as they can damage the fabric, coating, and prints.
2. Allow time for the wing to completely dry. Adhesives will not bond to a damp wing.
3. Lay the wing on a surface that is flat, clean, dry and smooth.
4. Cut or use two pieces of Canopy Repair Patch the same size, ensuring they are big enough to create a 15mm boarder around the entire tear. Round the corners of the patches to reduce the potential for peeling.
5. While the canopy is on a flat surface, place one patch over the affected are. Ensure the area is flat and free from wrinkles.
6. Cover the opposite side of the tear with the second remaining patch in the same way previously mentioned.
7. Make sure the patch is secure, especially at the edges.
8. It is recommended that the patch is given 12 hours to effectively adhere to the canopy surface before use.

SERIAL NUMBER

Located on the inner Wing tip of the Wing.

AIR WING AIM 5.0

AZTRON

R I D E I N T E L L I G E N T L Y



2 2 1 1 2 2 0 3 0 0 2 1
MADE IN CHINA

AZTRONSPORTS.COM

LIMITED WARRANTY



Aztron Sports warranties our products to be free from major defects in material or workmanship to the original purchase ONLY, for a period of 365 days* from the date of purchase.

**Warranty period may vary by country of purchase.*

THIS WARRANTY IS SUBJECT TO THE FOLLOWING LIMITATIONS:

1. The warranty is valid only when the warranty registration or warranty card is completed and returned within 30 days of date of purchase.
2. Warranty registration or warranty card must be accompanied by the original purchase receipt in which the name of retailer and date of purchase must be clear and legible.
3. Warranty is only valid when the product is used for its normal intended recreational use and will not cover products used in teaching, rental operations or other commercial purpose.
4. Aztron will make the final warranty determination, which may require inspection and/or photos of the equipment which clearly show defects. If necessary, this information must be sent to your point of purchase, or your country's Aztron distributor, postage prepaid.
5. If Aztron deems the products defective, the warranty only covers the repair or replacement of the defective product. Aztron will not be responsible for any costs, losses or damages incurred as a result of the loss of use of this product.
6. The warranty does not cover damage caused by misuse, abuse, neglect or normal wear or tear including, but not limited to: punctures, riggings with other than Aztron components, damage due to excessive sun exposure or hot temperatures such as inside an unventilated car, damage due to the product being stored in temperatures exceeding 45 degrees Celsius, damage caused by improper handling and storage, damage caused by use in waves or shore breaks, damage caused by using any inappropriate tools or any tool other than those specified within the installation guides and user manuals, damage caused by neglect of the care and maintenance instructions provided within the installation Guides and User Manuals.
7. This warranty is void if any repair, change or modifications has been made without authorization to any part of the equipment.
8. The warranty for any repaired or replaced equipment is good from the date of the original purchase date only.

9. All warranty claims must be accompanied by a digital copy of the original purchase receipt in which the name of the official retailer and date of purchase must be clear and legible.
10. There are no warranties that extend beyond the warranty specified herein.

For any warranty claims please contact your AZTRON retailer. A claim form can be download from the AZTRON website.



WARRANTY REGISTRATION CARD

Date of Purchase: _____ Model: _____

Serial Number: _____

Dealer/Store Name: _____

Dealer/Store Address: _____

State/Province: _____ Zip/Postal Code: _____

Country: _____ Mr. ☐ Mrs. ☐ Ms. ☐

Surname: _____ Name: _____

Address: _____

State/Province: _____ Zip/Postal Code: _____

Country: _____

Telephone Number: () _____

Email: _____



www.aztronsports.com